

PORT CREDIT HARBOUR WEST PARKS

*Port Credit Memorial Park (West), Pedestrian Underpass,
Marina Park and Boardwalk at Rivergate Easement*

Cycling Committee

May, 2021



AGENDA



SHOREPLAN



1. Introductions & Opening Remarks
2. Site Context
3. Design Development
4. Cycling plan

PORT CREDIT HARBOUR WEST PARKS



INTRODUCTIONS & OPENING



SHOREPLAN



REMARKS

Randy Jamieson- City of Mississauga
Ian Dance - Dillon Consulting Limited
Shahrzad Nezafati - Dillon Consulting Limited

PORT CREDIT HARBOUR WEST PARKS

SITE CONTEXT



SHOREPLAN



PORT CREDIT HARBOUR WEST PARKS

EXISTING CONDITIONS



Marina Park – Facing North



Marina Park – Facing South

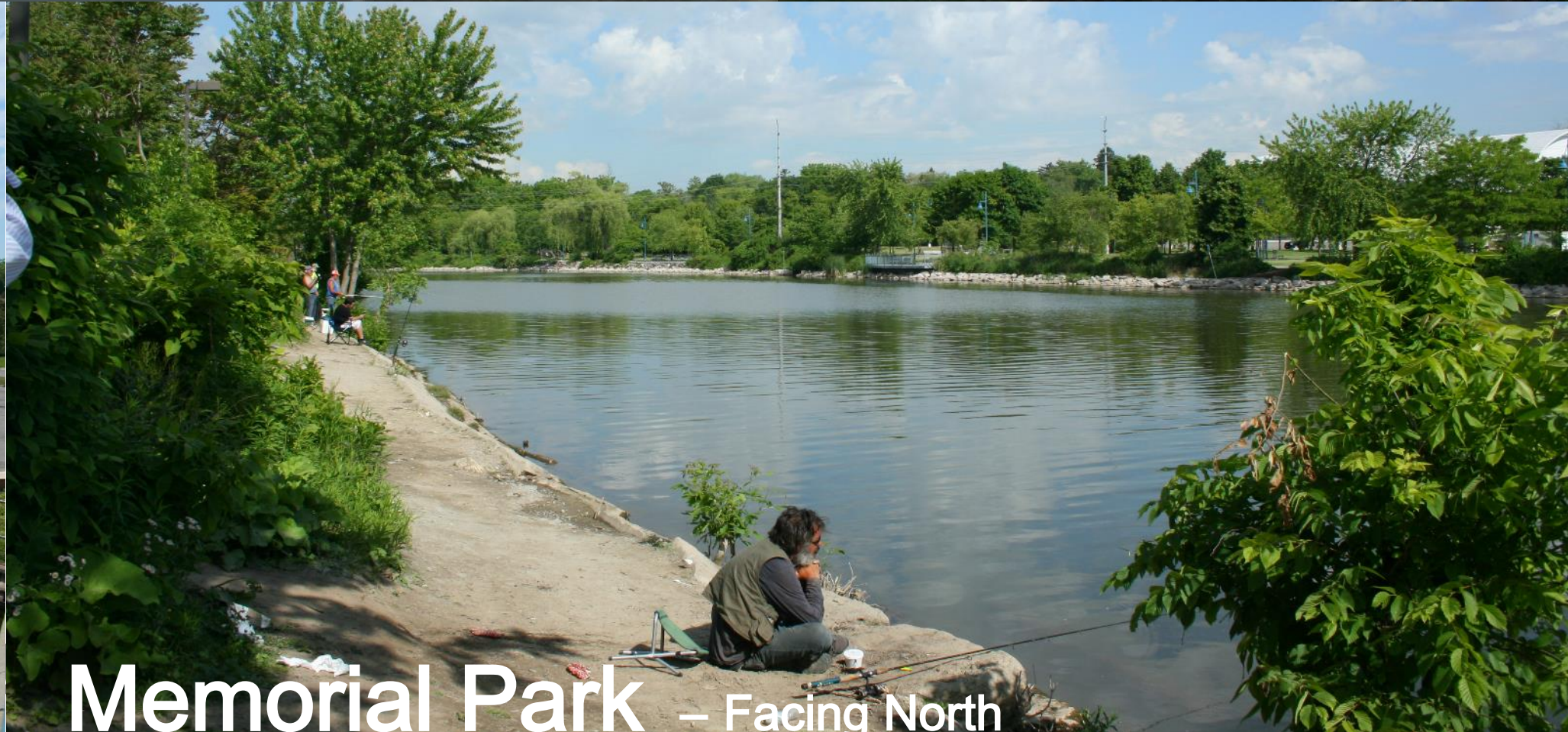

Memorial Park – Facing North

SITE OVERVIEW



SHOREPLAN

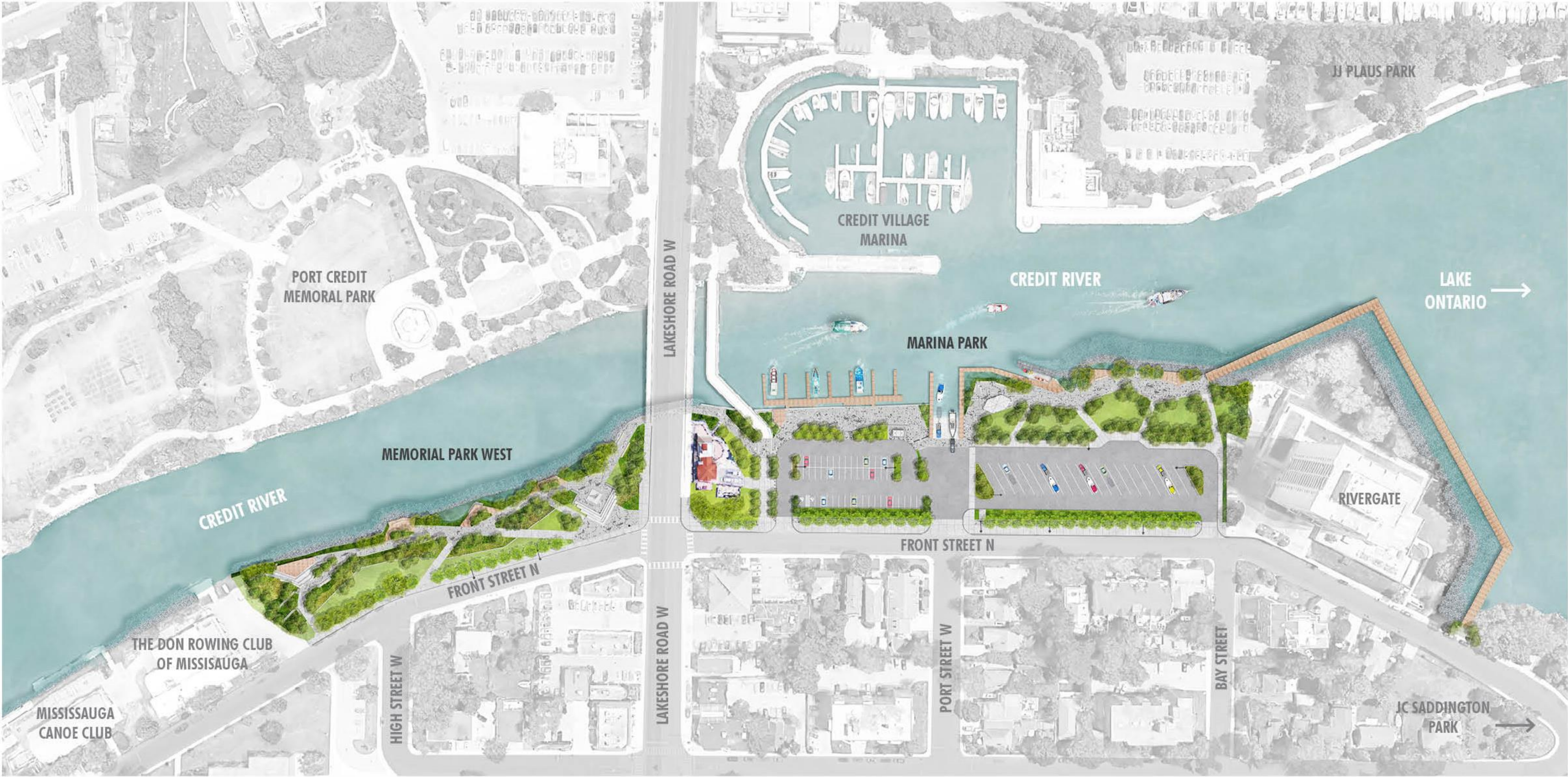

PORT CREDIT HARBOUR WEST PARKS

MAJOR ELEMENTS



SHOREPLAN

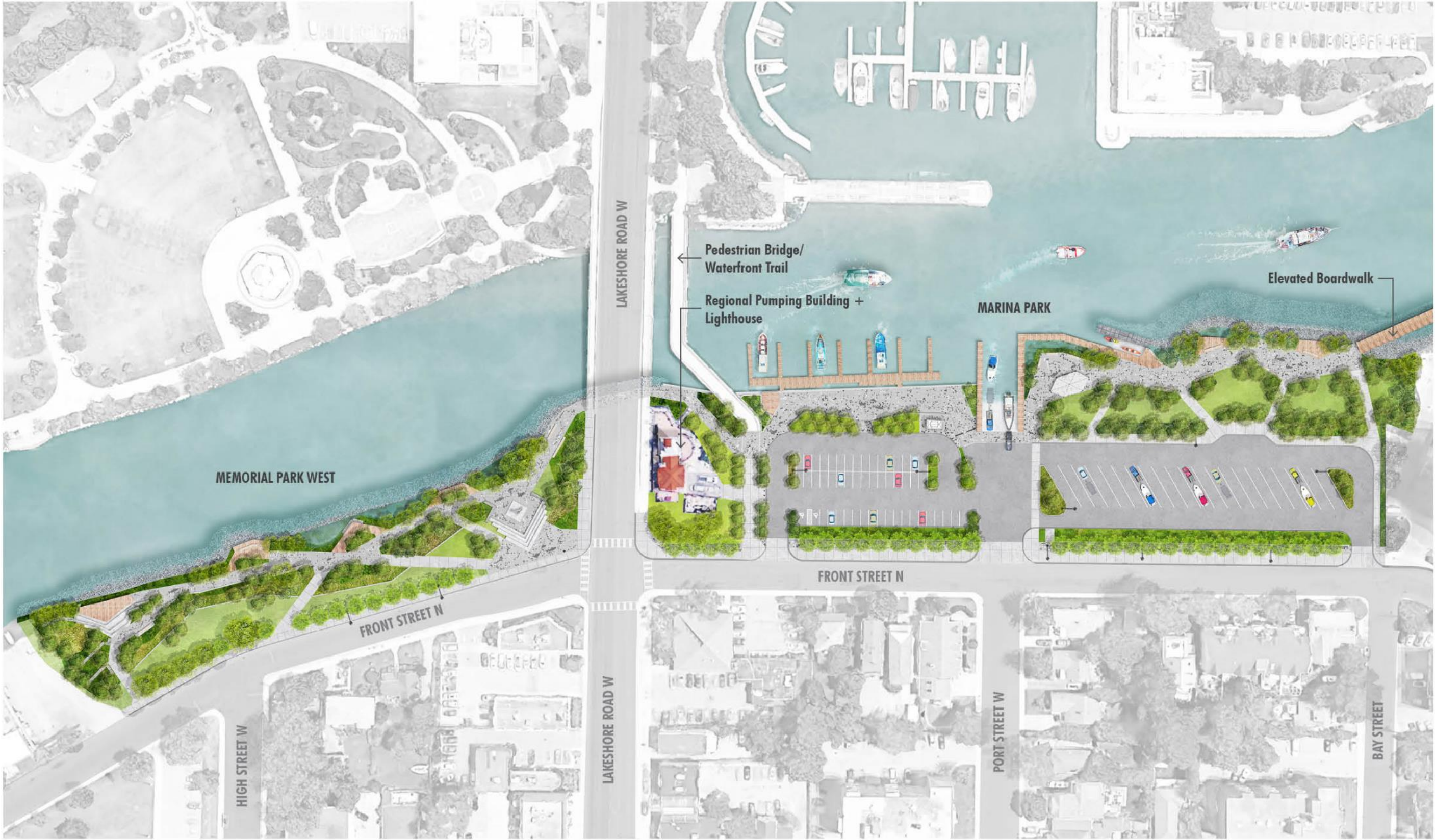

PORT CREDIT HARBOUR WEST PARKS

MEMORIAL PARK



SHOREPLAN



PORT CREDIT HARBOUR WEST PARKS

MEMORIAL PARK – Cross section

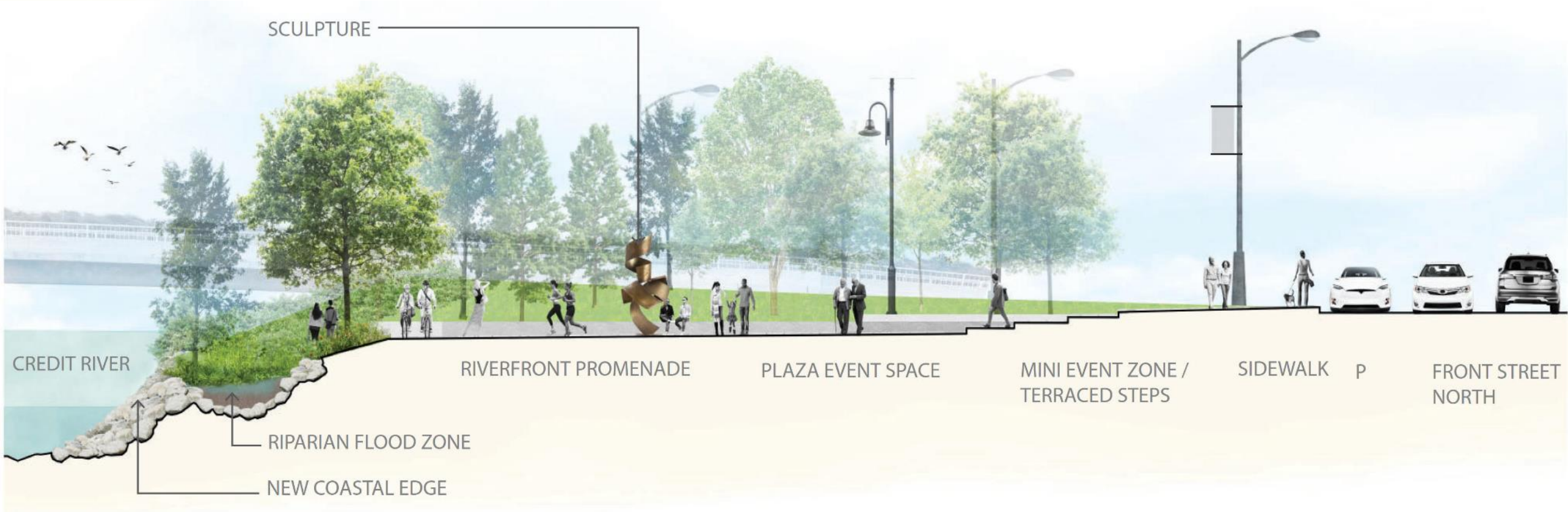
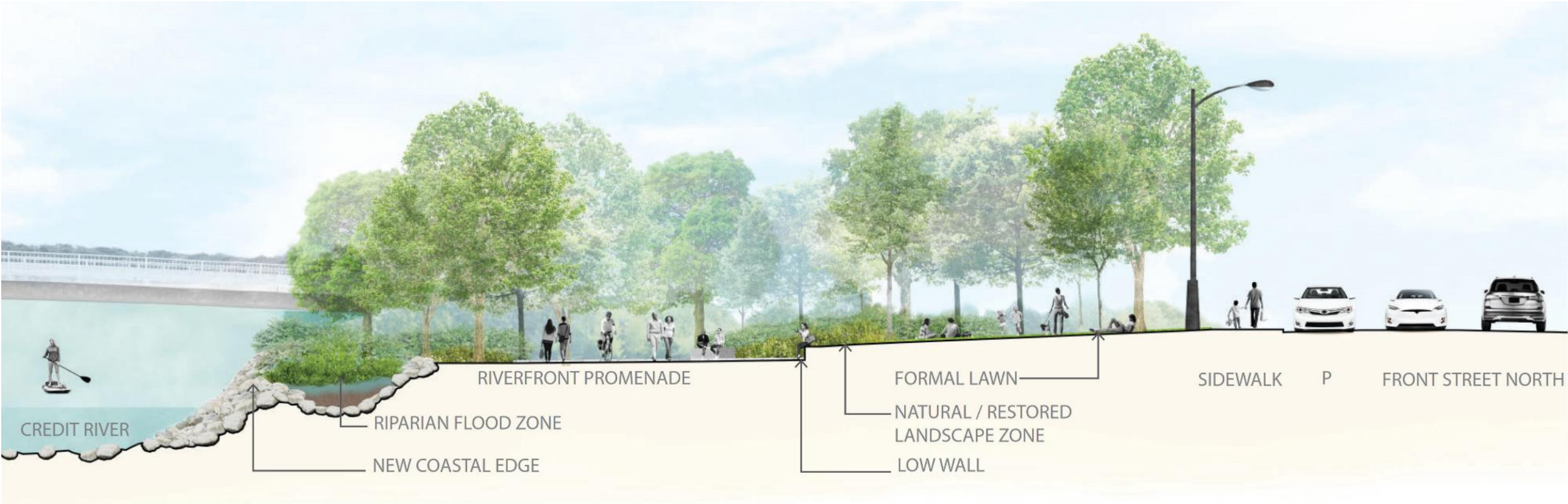

PORT CREDIT HARBOUR WEST PARKS

MARINA PARK



SHOREPLAN



PORT CREDIT HARBOUR WEST PARKS

MARINA PARK – Cross Section



SHOREPLAN

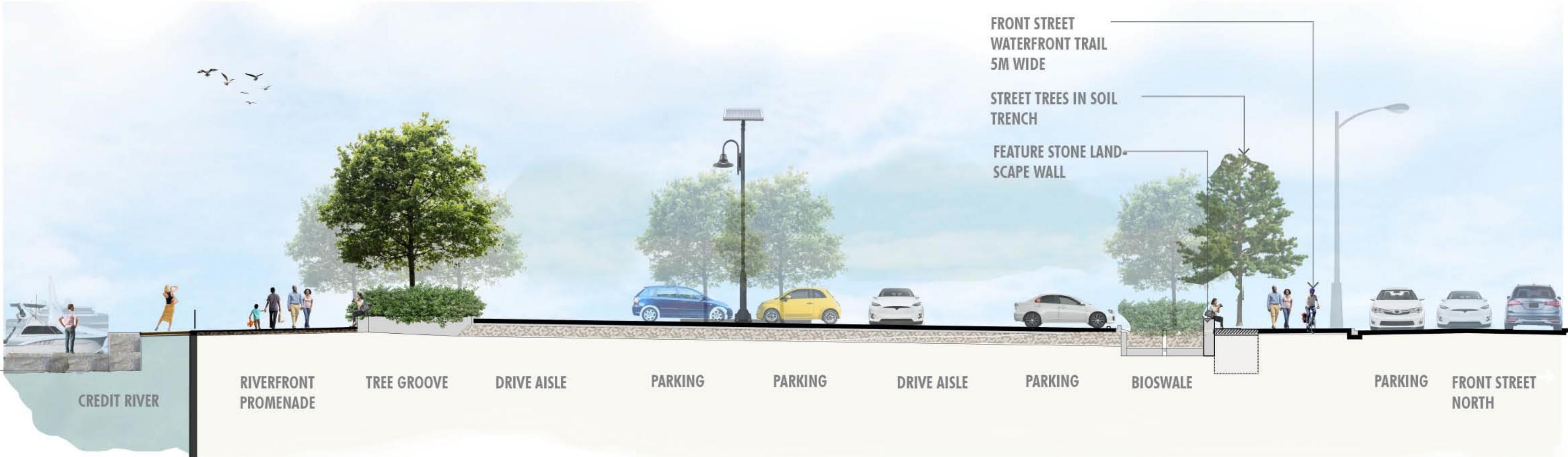

PORT CREDIT HARBOUR WEST PARKS

CYCLING PLAN



SHOREPLAN

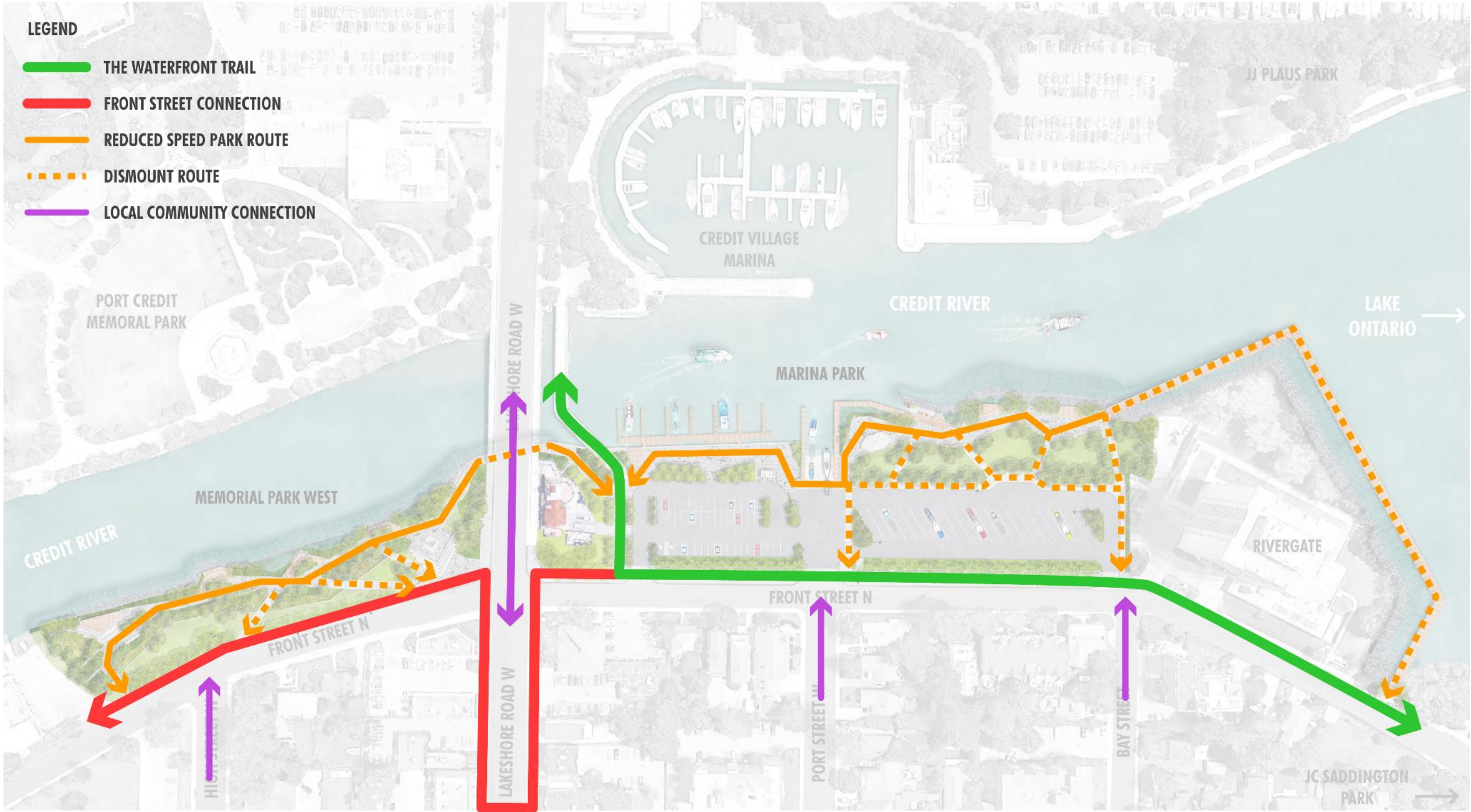

PORT CREDIT HARBOUR WEST PARKS

FRONT STREET CONNECTION

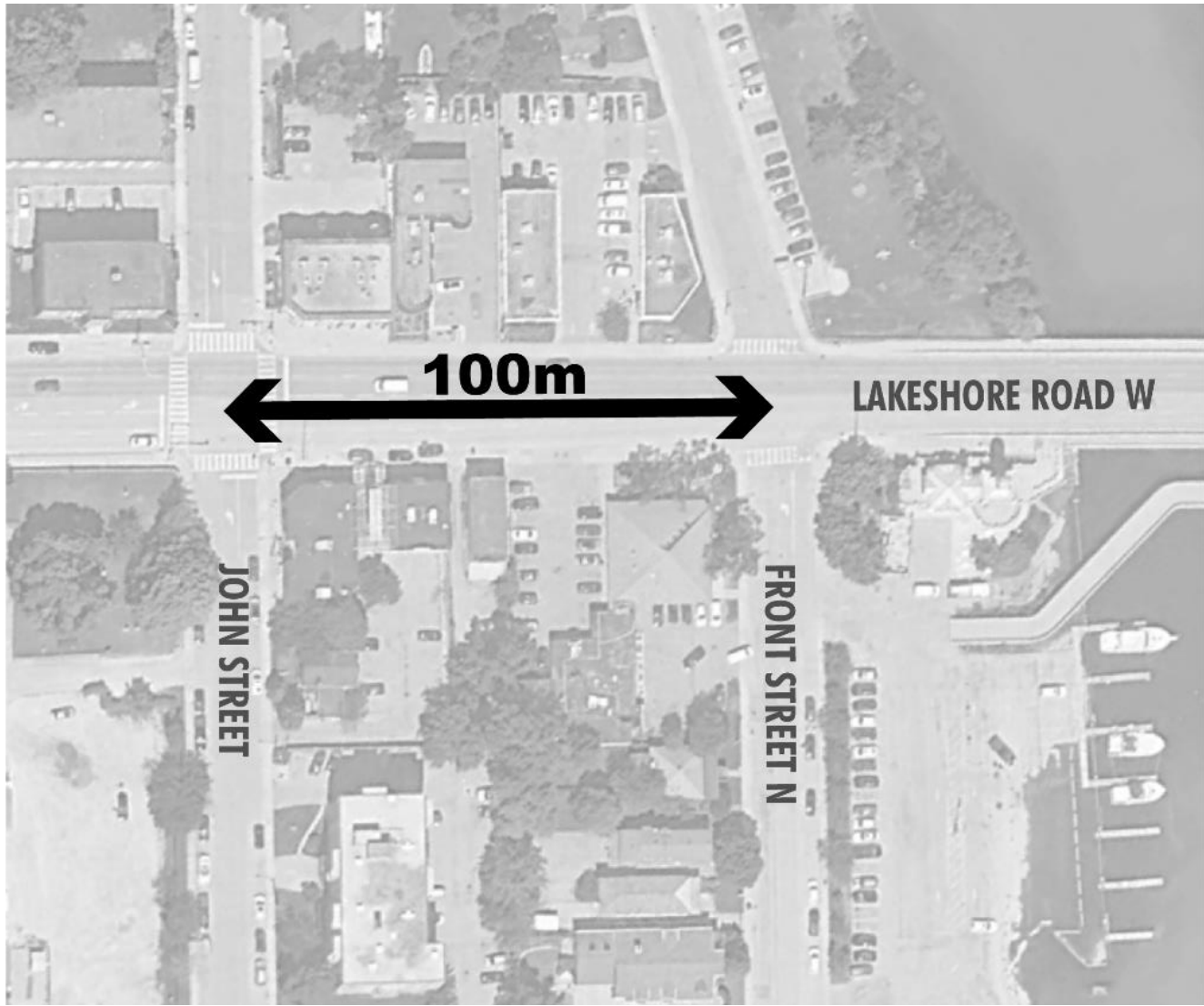

PORT CREDIT HARBOUR WEST PARKS

POSSIBLE BIKE RACK LOCATIONS

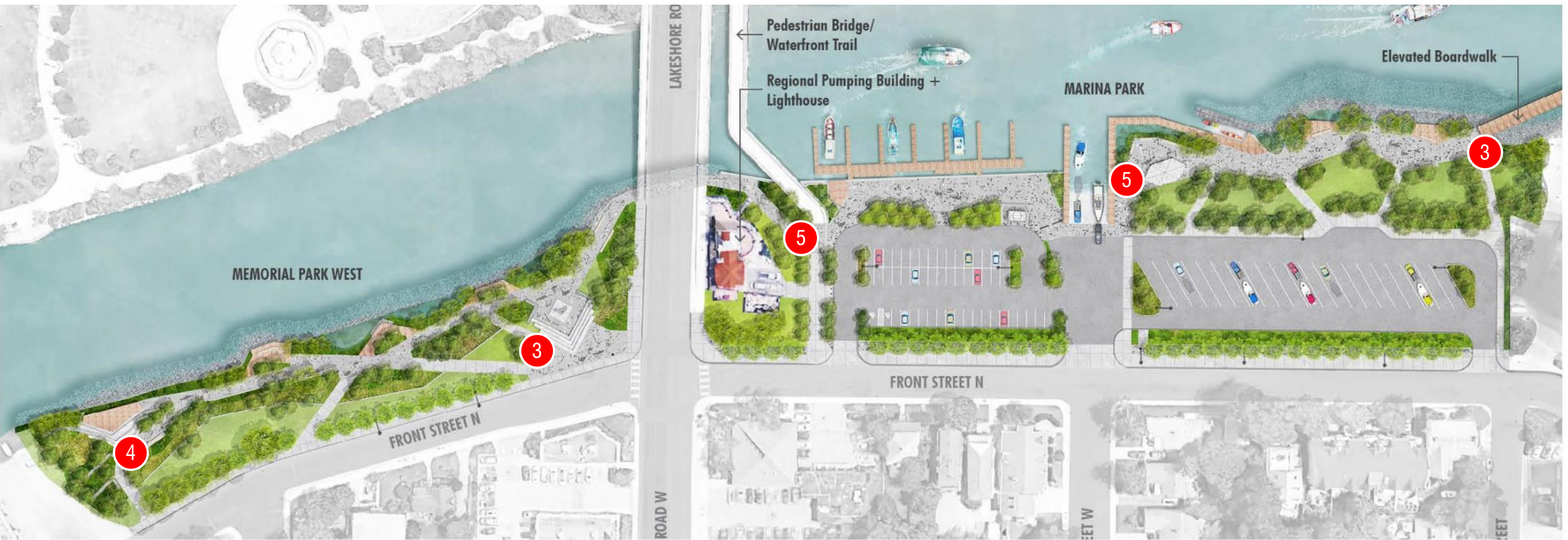

Possible Bike Rack Locations + Quantity

PORT CREDIT HARBOUR WEST PARKS

POSSIBLE BIKE RACK LOCATIONS



SHOREPLAN



Landscape Forms FGP Bike Rack

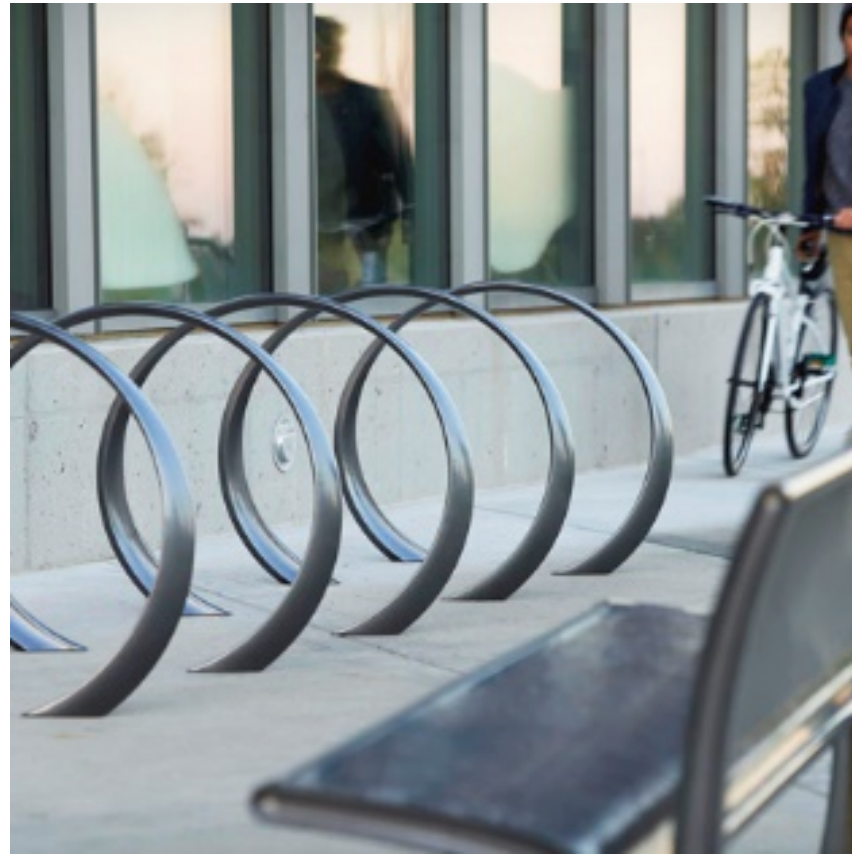

Landscape Forms Loop Bike Rack



Maglin SC Bike Rack



Maglin Mug Bike Rack

PORT CREDIT HARBOUR WEST PARKS

SUMMARY / QUESTIONS

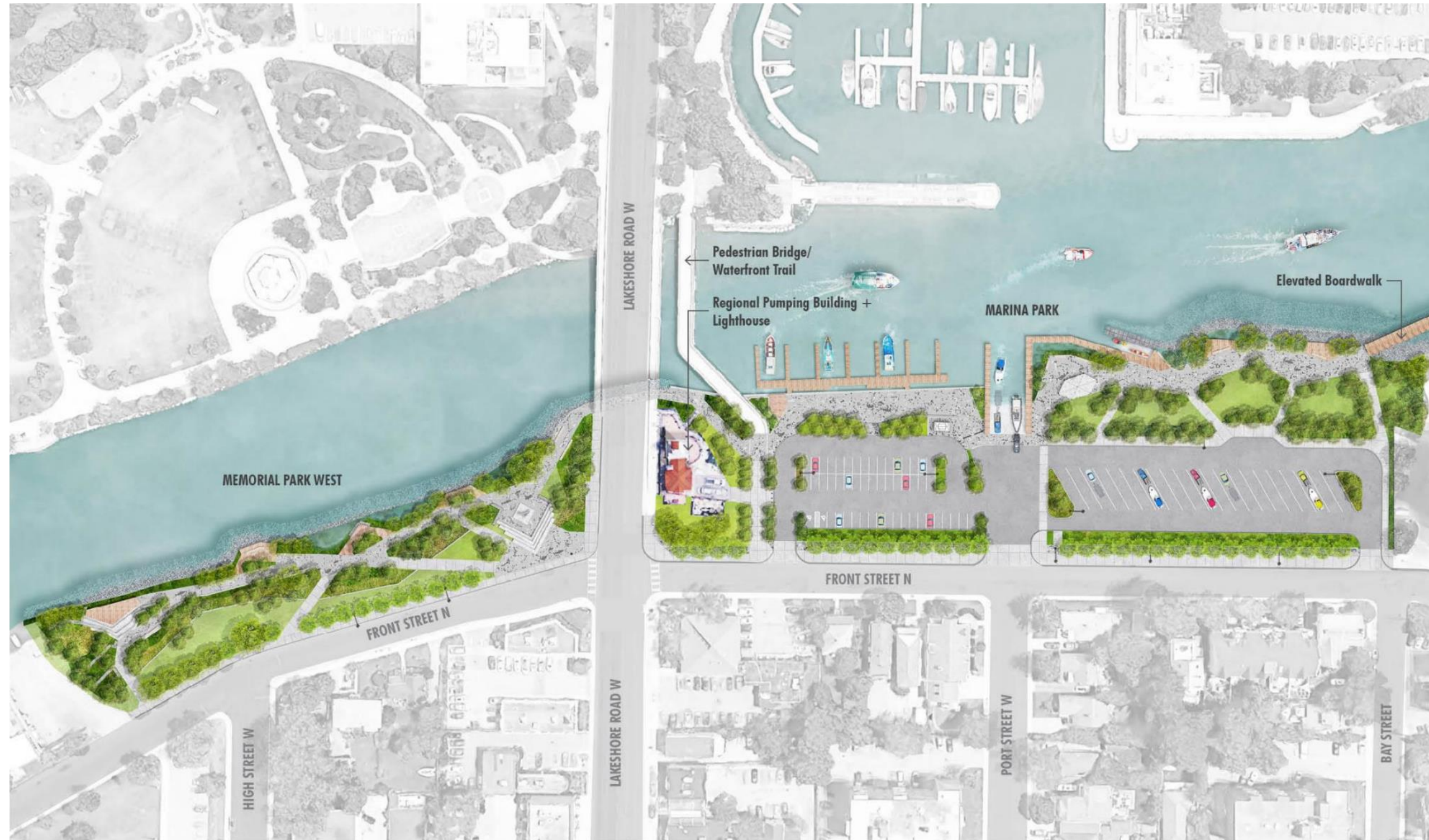

Project Update Meeting, March 3rd, 2021

Overview of safety considerations for cyclists

Key Takeaways:

- Cycling access is desired, including a connected network, and adequate infrastructure (parking)
- A crosswalk was contemplated for pedestrian safety at Lakeshore Road and Front Street, but following traffic review was not approved.
- There are concerns about the underpass flooding and the potential need to elevate the boardwalk, however current elevation and the height of the bridge cannot accommodate any additional elevation

While there will be pedestrian enhancements to the foot path underneath the bridge, this trail should also accommodate cyclists via multi-use recreational trail design. It was discussed that traffic calming measures at-grade at Lakeshore Road and Front Street North might be needed, but that falls out of the scope of this project. Currently we propose a connection at John Street.

PORT CREDIT HARBOUR WEST PARKS



SHOREPLAN



THANK YOU!

PORT CREDIT HARBOUR WEST PARKS