

Design & Massing, Environment and Unit Types

Terry Chemij

May 2023

Trapper's Green Park on Folkway Dr.

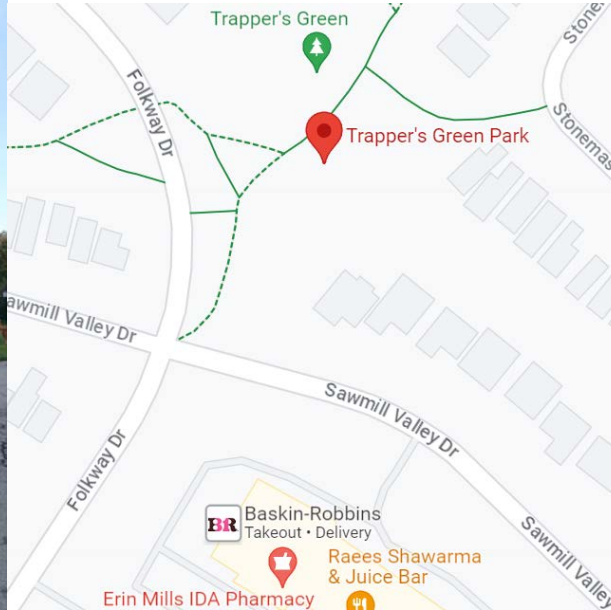

Community Access to Plaza: SW Corner Folkway Dr. and Sawmill Valley Dr.



Community access point replaced with a 7-story building



Shadow impact



Sept 21- 8:35am



June 21- 7:07am

Lack of green space and environmental components

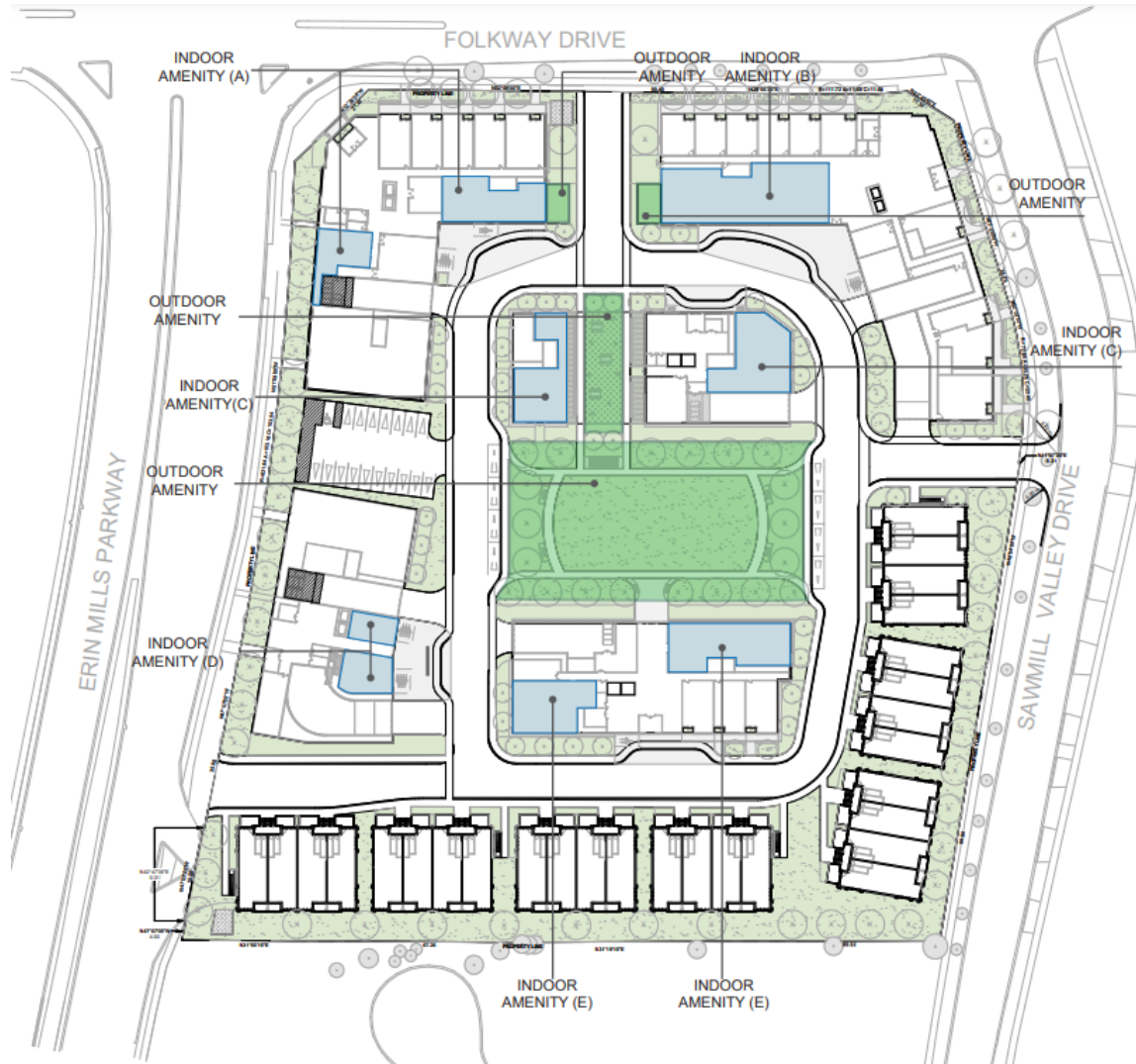

Gross Site: 6.5 acres (2.6 hectares)

Proposed outdoor amenity space 2,330.4m² of which 2,018m² are "open" which represents less than 9% green space

Proposed Unit Types

	One Bedroom	Two Bedrooms	Two Bedrooms + Den	Three Bedrooms
# of units	384	119	57	31
% of units	65%	29.8%	5.2 %	

The total number of 2 bedroom units of constructed, registered/mid-registration condo apartment buildings in Mississauga is 6,452 or **51.3%**

10% 3 bedroom units City of Toronto Growing Up guidelines