

SCHEDULE OF CROSS-SECTIONS

| PART | CROSS-SECTION | STRATIFIED |
|------|---------------|------------|
| 1 | NONE | NO |
| 2 | A-A, B-B, C-C | YES |
| 3 | A-A, B-B, C-C | NO |
| 4 | B-B | YES |
| 5 | A-A | YES |

SCHEDULE

| PART | LOT | REGISTERED PLAN | FIN. |
|------|--|-----------------|-------------------|
| 1 | PART OF INGLEWOOD DRIVE | 325 | PART OF 13460-027 |
| 2 | PART OF UNNAMED ROAD | | PART OF 13461-031 |
| 3 | PART OF BLOCK A AND PART OF UNNAMED ROAD | 325 | PART OF 13461-031 |
| 4 | PART OF UNNAMED ROAD | | PART OF 13461-031 |
| 5 | PART OF UNNAMED ROAD | | PART OF 13461-031 |

PLAN 43R-41204
 Received and deposited
 January 25th, 2024
 Janella Barrett
 Representative for the
 Land Registrar for the
 Land Titles Division of
 Peel (No.43)

STRATA PLAN OF SURVEY OF
 PART OF INGLEWOOD DRIVE
 REGISTERED PLAN 325
 AND PART OF BLOCK A AND
 PART OF UNNAMED ROAD,
 REGISTERED PLAN 325
 (CLOSED BY ORDER-IN-COUNCIL
 CC-2698-87), AS IN INSTRUMENT VS45342)
 CITY OF MISSISSAUGA
 REGIONAL MUNICIPALITY OF PEEL

SCALE 1 : 250 METRES
 1 2 3 4 5 6
 THE INTENDED PLOT SIZE OF THIS PLAN IS 100.00m x 100.00m IN METRE BY 600.00mm IN HEIGHT WHEN PLOTTED AT A SCALE OF 1:250

DISTANCE NOTES - METRIC
 DISTANCES ARE IN METRES AND CAN BE CONVERTED TO FEET BY DIVIDING BY 0.3048.
 DISTANCES ARE GROUND AND CAN BE CONVERTED TO GRID BY MULTIPLYING BY THE CORRECTED SCALE FACTOR OF 0.999704

BEARING NOTES
 BEARINGS ARE TRUE ORICAL, DERIVED FROM OBSERVED REFERENCE POINTS BY DISTANT AND SELF-HORIZONTAL
 (SEE INTERGATION DATA TABLE FOR COORDINATES), AND ARE REFERRED TO LOW ZONE 17, NAD83 (ORIGINAL)
 (ADJUSTED TO H2024 IOR DATUM)

FOR BEARING COMPARISONS, THE FOLLOWING ROTATIONS WERE APPLIED:
 P4 = 1°02'00" COUNTER-CLOCKWISE

ELEVATION - NOTES
 ELEVATIONS ARE GEODETIC AND REFERRED TO COORDINATE REF1978 ADJUSTMENT (CALCULATED TO THE HIGHEST LOT DATUM) AND ARE REFERENCED TO BENCHMARK H2024027.
 ELEVATION = 83.57M

SURVEYOR'S CERTIFICATE
 I CERTIFY THAT:
 1. THE STRUCTURES SHOWN ON THIS PLAN ARE IN EXISTENCE.
 2. THE DIMENSIONS SHOWN ON THIS PLAN HAVE BEEN VERIFIED BY ACTUAL MEASUREMENTS

JANUARY 16, 2024
 DATE
 LAWRENCE O. ERTL, O.L.S.

SURVEYOR'S CERTIFICATE
 I CERTIFY THAT:
 1. THIS SURVEY AND PLAN ARE CORRECT AND IN ACCORDANCE WITH THE SURVEY ACT, THE SURVEYORS ACT, THE LAND TITLES ACT AND THE REGULATIONS UNDER THEM.
 2. THE SURVEY WAS COMPLETED ON JANUARY 15, 2024

JANUARY 16, 2024
 DATE
 LAWRENCE O. ERTL, O.L.S.

INTERGATION DATA
 SHIPPED CONTROL POINT DATA FOR ONE (1) MARK (ORIGINAL) (CLOSED TO H2024 IOR DATUM)

| UNION ACCURACY PER SEC. 14(1), O.S.B. 20/15 | ESTIM. |
|---|---------|
| POINT 2 | 4000000 |
| POINT 3 | 4000000 |
| POINT 4 | 4000000 |
| POINT 5 | 4000000 |
| POINT 6 | 4000000 |

IBW SURVEYORS.COM | 1.800.667.0666
 1800 RIVER ROAD, MISSISSAUGA, ONTARIO L4X 1L7
 TEL: 905.276.8888 FAX: 905.276.8889

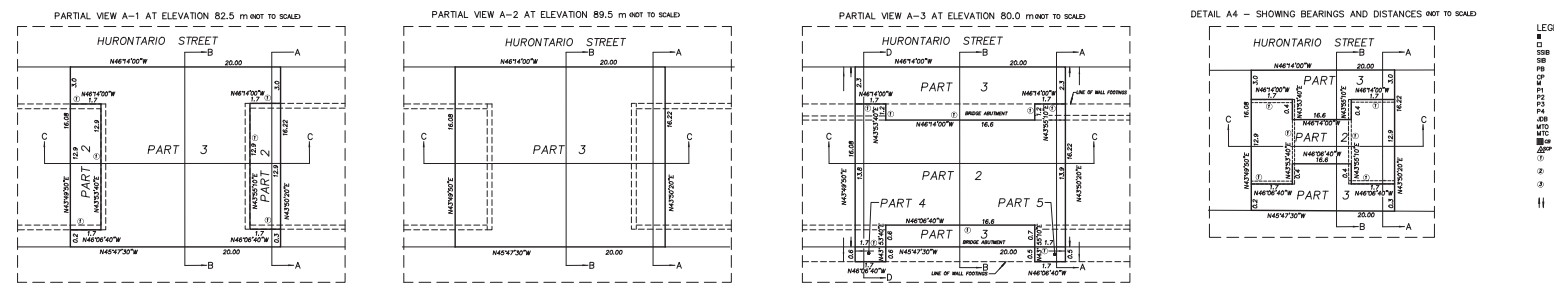
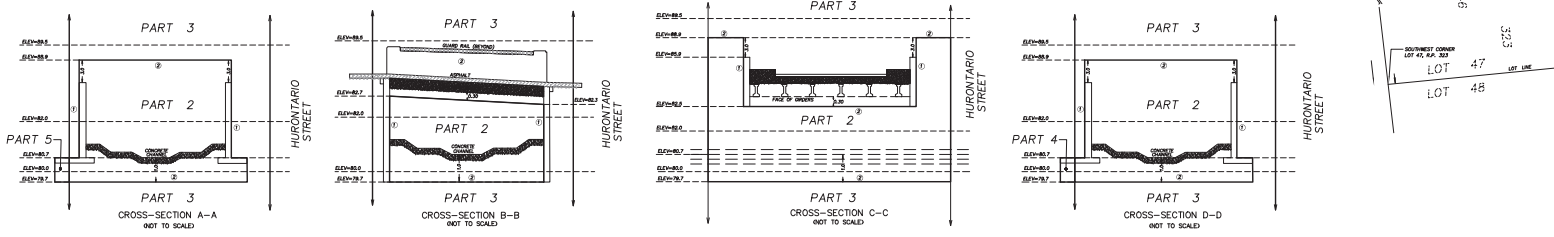

- LEGEND**
- 18 DENOTES SURVEY MONUMENT FOUND
 - 19 DENOTES SURVEY MONUMENT SET
 - 20 DENOTES SHORT STANDARD IRON BAR
 - 21 DENOTES STANDARD IRON BAR
 - 22 DENOTES PLASTIC BAR
 - 23 DENOTES CONCRETE PIN
 - 24 DENOTES CONCRETE BUSH
 - 25 DENOTES PLAN 43R-3650
 - 26 DENOTES PLAN 43R-3528
 - 27 DENOTES PLAN 43R-17928
 - 28 DENOTES J.D. BARNES LTD., O.L.S.
 - 29 DENOTES MINISTRY OF TRANSPORTATION & COMMUNICATION
 - 30 DENOTES GATION BASIN
 - 31 DENOTES SPECIFIED CONCRETE AND OVERLAY
 - 32 DENOTES FACE OF UNFINISHED CONCRETE
 - 33 DENOTES PROJECTIONS THEREOF
 - 34 DENOTES HORIZONTAL PLANE DEFINED BY OFFSET DIMENSIONS
 - 35 DENOTES VERTICAL PLANE DEFINED BY OFFSET DIMENSIONS
 - 36 DENOTES NO VERTICAL LIMITATION