

City of Mississauga

Memorandum:

City Department and Agency Comments

Date Finalized: 2024-12-04	File(s): A544.24
To: Committee of Adjustment	
From: Committee of Adjustment Coordinator	Meeting date:12/12/2024 3:30:00 PM

Consolidated Recommendation

The City has no objections to the application.

Application Details

The applicant requests the Committee to approve a minor variance to allow a below grade entrance proposing:

1. An exterior side yard setback of 4.47m (approx. 14.67ft) whereas By-law 0225-2007, as amended, requires a minimum exterior side yard setback of 4.50m (approx. 14.76ft) in this instance;
2. A below grade stairwell in the exterior side yard whereas By-law 0225-2007, as amended, does not permit a below grade stairwell in the exterior side yard in this instance.

Background

Property Address: 3681 Bloomington Cres

Mississauga Official Plan

Character Area: Churchill Meadows Neighbourhood
Designation: Residential Low Density II

Zoning By-law 0225-2007

Other Applications: SEC UNIT 24-4161

Zoning: R6 - Residential

Site and Area Context

The subject property is located north-west of the Thomas Street and Churchill Meadows Boulevard intersection in the Churchill Meadows Neighbourhood Character Area. It is a corner lot containing a two-storey detached dwelling with an attached garage. Limited landscaping and vegetative elements are present on the subject property. The surrounding area context is exclusively residential, consisting of detached and semi-detached dwellings on similarly sized lots.

The applicant is proposing to construct a below grade entrance to facilitate an additional residential unit requiring variances for side yard setback and location of the below grade entrance.

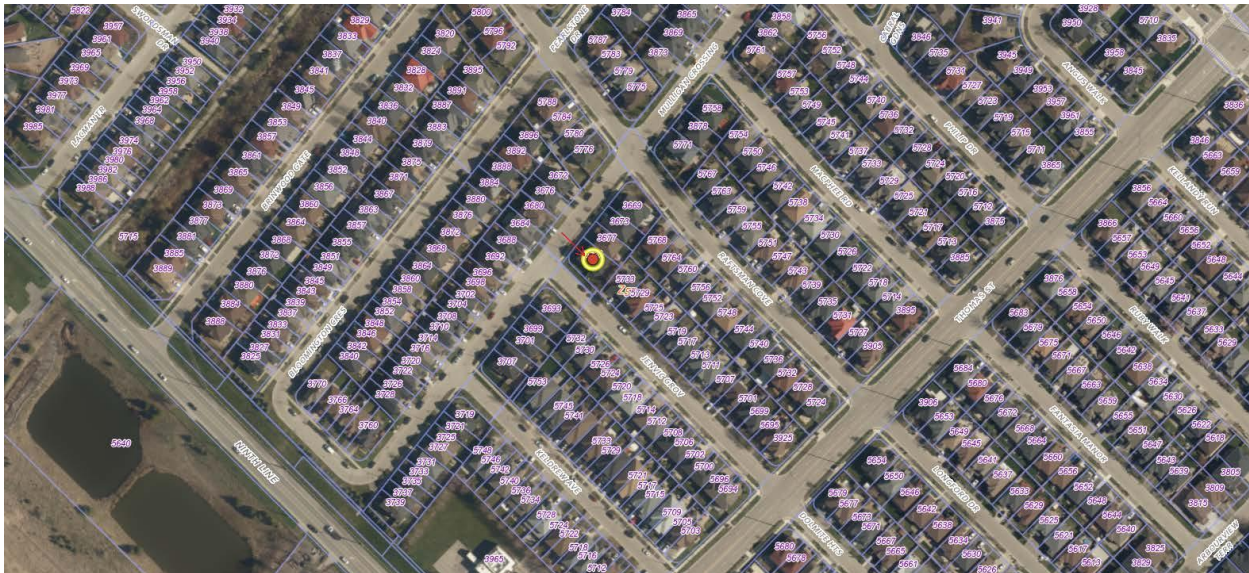

Comments

Planning

Section 45 of the *Planning Act* provides the Committee of Adjustment with the authority to grant relief from the requirements of a municipal zoning by-law. Approval of applications must meet the requirements set out under 45(1) and/or 45(2) (a) or (b) in the *Planning Act*.

Staff comments concerning the application of the four tests to this minor variance request are as follows:

The subject property is located in the Churchill Meadows Neighbourhood Character Area and is designated Residential Low Density II in Schedule 10 of the Mississauga Official Plan (MOP). Section 9 of MOP promotes development with appropriate urban form and site design, regulating

that such development is compatible with the existing site conditions, the surrounding context, and the landscape of the character area. Staff note that the entrance will be appropriately screened from the streetscape with a proposed privacy fence ensuring compatibility with the surrounding context.

The sole variance requests a below grade stairwell to be located in the exterior side yard. The intent of the exterior side yard regulation is to ensure that an adequate buffer exists between a structure and the public realm, and to ensure the entrance does not negatively impact the overall streetscape. In this instance, the applicant is proposing to locate the entrance behind the proposed privacy fence which will appropriately screen the stairwell from view.

Staff are satisfied that any negative impact to the streetscape is appropriately mitigated and that the proposal meets the general intent and purpose of the official plan and zoning by-law. Furthermore, the proposal contributes to orderly development of the subject property whose impacts to the streetscape and abutting properties are minor in nature.

Comments Prepared by: Daniel Grdasic, Committee of Adjustment Planner

Appendices

Appendix 1 – Transportation and Works Comments

As the subject lot this is a corner lot and the below grade entrance is being proposed in an area which will not impact the existing drainage pattern or any of the adjacent properties, we have no drainage related concerns with the location of the below grade entrance.





Comments Prepared by: Tony Iacobucci, Development Engineering

Appendix 2 – Zoning Comments

The Building Division is processing Building Permit application SEC UNIT 24-4161. Based on the review of the information available in this application, the requested variance(s) is/are correct.

Our comments may no longer be valid should there be changes in the Committee of Adjustment application that have yet to be submitted and reviewed through the Building Division application. To receive updated comments, the applicant must submit any changes to information or drawings separately through the above application.

Comments Prepared by: Minan Song, Zoning Examiner

Appendix 3 – Parks, Forestry & Environment

Forestry Comments

The Forestry Section of the Community Services Department has reviewed the above noted minor variance application and advises as follows:

1. No public trees shall be injured or removed. If public tree injury or removal is required, a permit must be issued as per By-law 0020-2022.
2. No private trees shall be injured or removed. If a private tree with a diameter of 15 centimetres or greater on private property is to be injured or destroyed, a permit must be issued as per By-law 0021-2022.
3. Please note if a tree is identified as a shared tree with the adjacent property owner, and the applicant intends to apply for a Tree Removal Permit, written consent must be obtained by both parties.

A Tree Removal Application to Permit the Injury or Destruction of Trees on Public and Private Property can be found at <https://www.mississauga.ca/publication/application-to-permit-the-injury-or-destruction-of-trees-on-public-and-private-property/>.

Should further information be required, please contact Jamie Meston, Landscape Technician, Forestry Section, Community Services Department at 905-615-3200 ext. 4264 or via email jamie.meston@mississauga.ca.

Comments Prepared by: Jamie Meston, Landscape Technician

Appendix 4 – Region of Peel Comments

Minor Variance Application: A-24-544M / 3681 Bloomington Crescent

Development Engineering: Wendy Jawdek (wendy.jawdek@peelregion.ca)(905) 791-7800
x6019

Comments:

- Please be advised that service connection sizes shall be in compliance with Ontario Building Code and Region of Peel Design Criteria. An upgrade of your existing service may be required.
- Any changes to the underground water or sanitary sewer will require review by the Region of Peel. Site Servicing approvals are required prior to the local municipality

issuing building permit. For more information, please contact Servicing Connections by email at siteplanservicing@peelregion.ca.

Comments Prepared by: Petrele Francois, Junior Planner